

VERY IMPORTANT: Save This Booklet.
Carefully read the cautions in this manual before
using your new Browning firearm.

A-BOLT

BROWNING A-BOLT
BOLT ACTION RIFLE

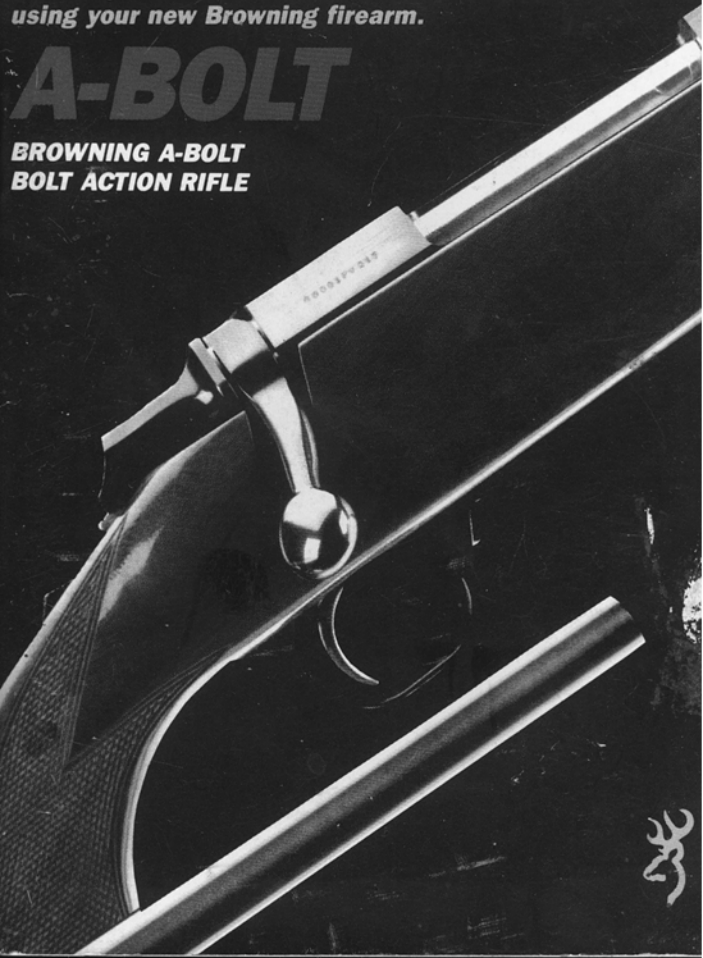

New Gun Owner's Record

(KEEP THIS FOR FUTURE REFERENCE)

Browning Model

Serial Number

Caliber

Purchase Price

Purchased From

Date of Purchase

Please fill out and mail the Market Survey Card at the back of this booklet.

We are pleased that you have chosen a Browning A-Bolt bolt action rifle.

It is certainly a gun you can be proud to own. The A-Bolt incorporates design concepts and features developed over years of testing and use in the field, as well as new, innovative ideas. Ideas and features that make hunting and shooting more enjoyable and safer than ever. In every sense, the A-Bolt rifle is a true Browning. It gives you the kind of quality and dependability you've come to expect from the world's most respected gun company.

With a reasonable amount of care, your A-Bolt rifle should give you many years of dependable, enjoyable service. Please feel free to write us immediately if you have any important observations regarding its performance and operation.

Also, please take a moment to complete and mail in the brief, attached marketing survey card found on the back cover.

Thank You.

 **BROWNING** Route One, Morgan, Utah 84050

You are responsible for firearm safety

As a gun owner, you accept a set of demanding responsibilities. How seriously you take these responsibilities can be the difference between life and death. Mistakes made with guns are often final and cannot be paid for with money or regret.

There is no excuse for careless or abusive handling of any firearm. At all times handle your A-Bolt and any other firearm with intense respect for its power and potential danger.

PLEASE READ AND UNDERSTAND THE PROPER HANDLING PROCEDURES OUTLINED IN THIS BOOKLET BEFORE USING YOUR NEW FIREARM.

1 ALWAYS KEEP THE MUZZLE OF YOUR A-BOLT POINTED IN A SAFE

DIRECTION. Never point your gun at anything you do not intend to shoot.

2 DO NOT RELY TOTALLY ON YOUR FIREARM'S MECHANICAL "SAFETY" DEVICES. ALWAYS ASSUME THAT YOUR A-BOLT CAN BE FIRED WITH THE SAFETY

ON. The word "safety" describes a gun's blocking or disengaging mechanism for the trigger, sear, hammer and/or firing pin.

Although mechanical devices place your A-Bolt rifle in a SAFER status, no guarantee can be made that the gun will not fire even if the "safety" is on the "on safe" position.

Like any mechanical device, a safety can sometimes fail; it can be jarred or inadvertently manipulated into an unsafe condition. Mechanical "safeties" merely aid safe gun handling and are no excuse for pointing your rifle's muzzle in an unsafe direction.

Safe gun handling does not stop with your gun's mechanical "safety" devices. It starts there. Always treat your firearm with the respect due a loaded, ready-to-fire gun.

3 WHENEVER YOU HANDLE YOUR A-BOLT, OR HAND IT TO SOMEONE, ALWAYS OPEN THE ACTION immediately and visually check the chamber to be certain it does not contain a cartridge.

4 DO NOT TRANSPORT YOUR A-BOLT LOADED, whether in a scabbard, gun case, or other container.

5 BEWARE OF BARREL OBSTRUCTIONS. When preparing to shoot your A-Bolt, open the action and inspect the chamber and barrel. ***BE CERTAIN NO LIVE ROUND IS IN THE CHAMBER.*** With the action open, glance down the barrel to be

sure it is clear of any obstruction. It takes only a small obstruction to dangerously increase pressures. Before the first firing, clean the bore with a cleaning rod and patch, and wipe away any anti-rust compounds in the chamber and around the action. See "Care and Cleaning" on page 30.

6 BE CERTAIN YOUR RIFLE IS UNLOADED BEFORE CLEANING.

Because so many gun accidents occur when a firearm is being cleaned, special and extreme care should be taken to be sure your gun is unloaded before disassembly, cleaning and reassembly. Keep ammunition away from the cleaning location. Never test the mechanical function of any firearm with live ammunition.

7 ALWAYS UNLOAD YOUR GUN WHEN NOT IN USE.

Your responsibilities do not end when your firearm is unattended. Store your gun and ammunition separately and well beyond the reach of children. Take all safeguards to insure your gun does not become available to untrained, inexperienced or unwelcome hands.

8 USE THE PROPER AMMUNITION. The barrel and action of this rifle have been made with substantial safety margins over the pressures developed by established

American commercial loads. Nevertheless, Browning assumes no liability for accidents which occur through the use of cartridges of non-standard dimensions or which develop pressures in excess of commercially available ammunition which has been loaded in accordance with standards established by Sporting Arms and Ammunition Manufacturers' Institute (SAAMI).

9 EXAMINE EVERY CARTRIDGE YOU PUT IN YOUR A-BOLT RIFLE.

The caliber of your A-Bolt is inscribed on the right side of the barrel. Browning cannot assume any responsibility for the use of unsafe or improper arms and ammunition combinations. It is your responsibility to read and heed all warnings, including those that appear in the instruction manual and on ammunition boxes. Serious injury to yourself and damage to your gun may result from improper cartridge use.

10 DO NOT SNAP THE FIRING PIN ON AN EMPTY CHAMBER — THE CHAMBER MAY NOT BE EMPTY!

Treat every gun with the respect due a loaded gun, even though you are certain the gun is unloaded.

11 KEEP YOUR FINGER AWAY FROM THE TRIGGER WHILE UNLOADING AND

LOADING — UNTIL YOU ARE READY TO SHOOT.

12 HUNTING FROM ELEVATED SURFACES SUCH AS TREE STANDS IS DANGEROUS

and may increase the risk of handling your firearm. The following rules should always be observed by you and those you hunt with: Always make certain that your firearm is unloaded when it is being taken up and down from the stand. Always make certain that your firearm is not dropped from the stand. Remember, a loaded firearm may discharge when dropped, even with the safety on.

13 BE SURE OF YOUR TARGET AND BACKSTOP, particularly during low light periods. Know the range of your ammunition. Never shoot at water or hard objects.

14 DROPPING YOUR A-BOLT WHEN LOADED CAN CAUSE AN ACCIDENTAL DISCHARGE EVEN WITH THE SAFETY ON. Be extremely careful while hunting or during any shooting activity, to avoid dropping any firearm.

15 ALWAYS UNLOAD YOUR RIFLE'S CHAMBER AND OPEN THE BOLT BEFORE CROSSING A FENCE, CLIMBING A TREE,

JUMPING A DITCH OR NEGOTIATING OTHER OBSTACLES. Never lean or place your A-Bolt against a fence, tree, car or other similar object.

16 IF YOUR A-BOLT FAILS TO FIRE, KEEP THE MUZZLE POINTED IN A SAFE DIRECTION. Hold this position for a minimum of 30 seconds. Carefully open the action and remove the cartridge. If the primer is indented, the cartridge should be disposed of in a way that cannot cause harm. If the primer is not indented, your firearm should be examined by a qualified gunsmith and the cause of the malfunction should be corrected before further use.

17 WEAR EYE AND EAR PROTECTION WHEN SHOOTING. Unprotected, repeated exposure to gunfire can cause hearing damage. Wear hearing protectors to protect your ears from loud noise and shooting glasses to protect your eyes from flying particles. Also, wear eye protection when disassembling and cleaning your rifle to prevent the possibility of springs, spring-tensioned parts, solvents or other agents from contacting your eyes.

18 BE DEFENSIVE AND ON GUARD AGAINST UNSAFE GUN HANDLING

AROUND YOU AND OTHERS. Don't be timid when it comes to gun safety. If you observe other shooters violating any of these safety precautions, politely suggest safer handling practices.

19

SUPERVISE AND TEACH FIREARMS SAFETY TO ALL MEMBERS OF YOUR FAMILY — especially to children and nonshooters. Closely supervise newcomers to the shooting sports. Encourage enrollment in hunting/shooting safety courses.

20

NEVER DRINK ALCOHOLIC BEVERAGES OR TAKE ANY TYPE OF DRUGS BEFORE OR DURING SHOOTING. Your vision and judgment could be dangerously impaired, making your gun handling unsafe to you or to others.

21

PERIODIC MAINTENANCE — AVOID UNAUTHORIZED SERVICING. Your A-Bolt is a mechanical device which will not last forever, and as such, is subject to wear and requires periodic inspection, adjustment, and service. Like all Browning firearms, your A-Bolt should be serviced by a Browning recommended service center or by Browning's service facility in Arnold, Missouri. Browning cannot assume any responsibility for injuries suffered or caused

by unauthorized servicing, alterations or modifications of Browning firearms. **IT CAN BE VERY DANGEROUS TO ALTER THE TRIGGER OR OTHER FIRING MECHANISM PARTS OF THIS OR ANY OTHER FIREARM.**

BE CAREFUL!

General description of the Browning A-Bolt rifle

The A-Bolt is a bolt action operated rifle incorporating the most advanced features available today. The A-Bolt gives you a significant hunting advantage — less weight without shortening the barrel or sacrificing accuracy. Whichever model you choose, the finely finished Medallion or the hard-working Hunter, you can be sure you own a rifle that's a cut above the others.

The A-Bolt's short, 60° bolt throw lets you cycle the action rapidly for quick follow-up shots. Because the bolt does not swing up as high when open, scope clearance is improved. The bolt handle itself is human-engineered to fit your hand naturally.

The A-Bolt has a strong three-lug, thin-bodied bolt. Weight is reduced while maintaining the strength necessary to handle magnum calibers. Browning's cartridge depressor mechanism (pat. #4723369) makes it possible to have both a thin-bodied bolt and short bolt rotation.

Other significant features include the convenient hinged floorplate with detachable box magazine, thumb-operated top tang safety and clean styling. The distinctive smooth plane top of the

receiver provides a firm platform for scope mount placement.

General operation of the A-Bolt rifle

The A-Bolt is a bolt action rifle that operates by lifting the bolt handle, drawing the bolt rearward and then sliding the bolt forward and rotating the bolt downward until it stops. This process takes a cartridge from the magazine and loads it into the chamber for firing. **CAREFULLY READ THE FOLLOWING PROCEDURES BEFORE ATTEMPTING TO ASSEMBLE OR SHOOT YOUR A-BOLT RIFLE.**

Nomenclature

In conventional gun terminology the position and movement of gun parts are described as they occur with the gun horizontal and in normal firing position; i.e., the muzzle is forward or front; the butt stock is rearward or rear; the trigger is downward or underneath; the sights are upward or on top. For general nomenclature refer to Figure 1.

FIGURE 1

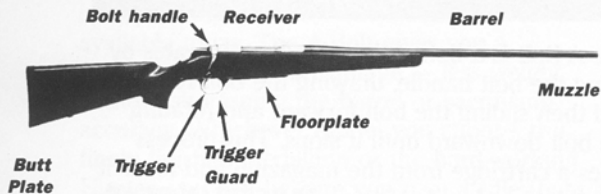

Serial Number

The serial number can be found on the right hand side of the receiver, in front of the bolt handle.

Initial Cleaning

BEFORE THE FIRST FIRING, CLEAN THE ANTI-RUST COMPOUND from the inside of the receiver with a clean rag and light gun oil such as Browning Oil. For an explanation of cleaning procedures see "Care and Cleaning" on page 30.

FIGURE 2

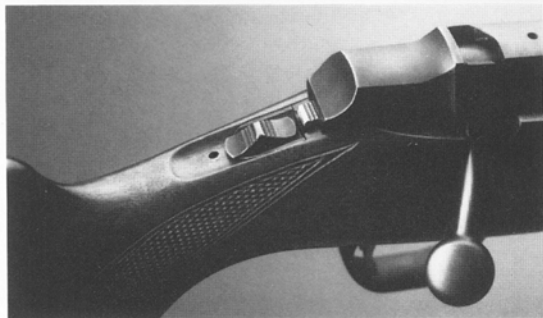

Operation of the safety

The safety is located on the top tang at the rear of the receiver. When the safety is drawn with the thumb to the rear, the gun is in the "on safe" position. This blocks the trigger and locks the bolt in the closed position. In this position an "S" will appear on the tang in front of the safety. **WHENEVER A CARTRIDGE IS CHAMBERED, THE RIFLE SHOULD BE KEPT IN THE "ON SAFE" POSITION UNTIL YOU ARE READY TO FIRE IT.** When the safety is pushed forward, the "S" will be covered and a red dot on the stock will appear indicating that the rifle is in the "off safe" position and ready to fire (See figure 2).

FIGURE 3

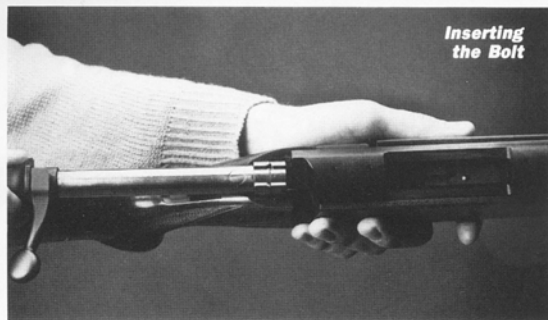

Inserting and removing the bolt

- 1 INSERTING THE BOLT** —The A-Bolt rifle comes packed in a foam-padded box with the bolt removed from the rifle. It is necessary to insert the bolt into the receiver. To do this, first place the safety in the “off safe” position. Align the forward end of the bolt in the rear opening of the receiver. Be sure the cartridge depressor is also aligned with the bottom bolt lug (See figure 3). Push the bolt completely forward and rotate the handle down to lock it (See figure 4). It is not necessary to depress the

FIGURE 4



bolt stop to insert the bolt. **RETURN THE THUMB-OPERATED SAFETY TO THE “ON SAFE” POSITION.** The rifle is now completely assembled and may be operated normally.

FIGURE 5

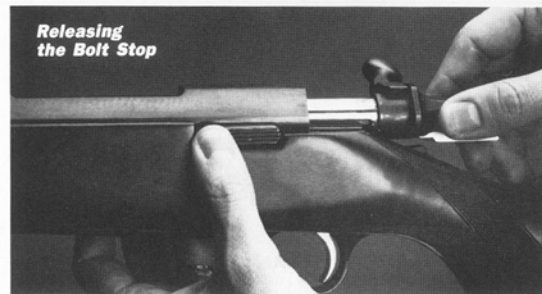

2

REMOVING THE BOLT — FIRST, CHECK TO MAKE CERTAIN THERE ARE NO CARTRIDGES IN THE CHAMBER OR MAGAZINE. Press in on the forward end of the bolt stop and draw the bolt to the rear completely removing it from the rifle. The bolt stop is the horizontal bar on the left side of the receiver (See figure 5).

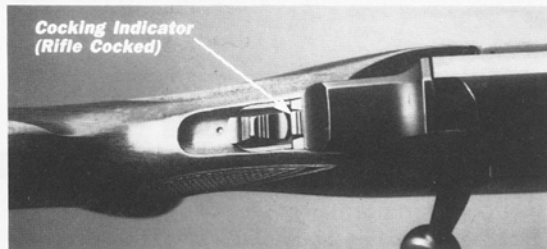
FIGURE 6

Cocking indicator

Below the bolt shroud and ahead of the safety is a serrated cocking indicator. The indicator is painted red. When the rifle is cocked it may be readily felt with the thumb as well as easily seen with a quick glance downward (See figure 6). When the rifle is fired, the cocking indicator retracts into the bolt shroud and cannot be seen or felt.

Loading the rifle

The Browning A-Bolt utilizes a unique detachable box magazine with a hinged floorplate. The magazine on standard calibers holds four rounds. On magnum calibers the capacity is three rounds.

1

LOADING WITH THE MAGAZINE ATTACHED TO THE FLOORPLATE —

Hold the rifle in the natural position with the barrel angled down toward the ground. The bolt may be in the open or closed position. **NOTE: IF THE BOLT IS IN THE**

FIGURE 7

BROWNING A-BOLT RIFLE

Schematic is provided for parts identification only and should not be used as a guide to assemble the rifle. Parts numbers listed are for the A-Bolt Medallion. See the parts list for A-Bolt Hunter part numbers.

IMPORTANT: When ordering parts, list code number, part name, caliber, model and serial number.

CAUTION: Browning parts are made exclusively for Browning guns and should not be used in other guns even though models may be similar. Inadequately fitted parts may be dangerous.

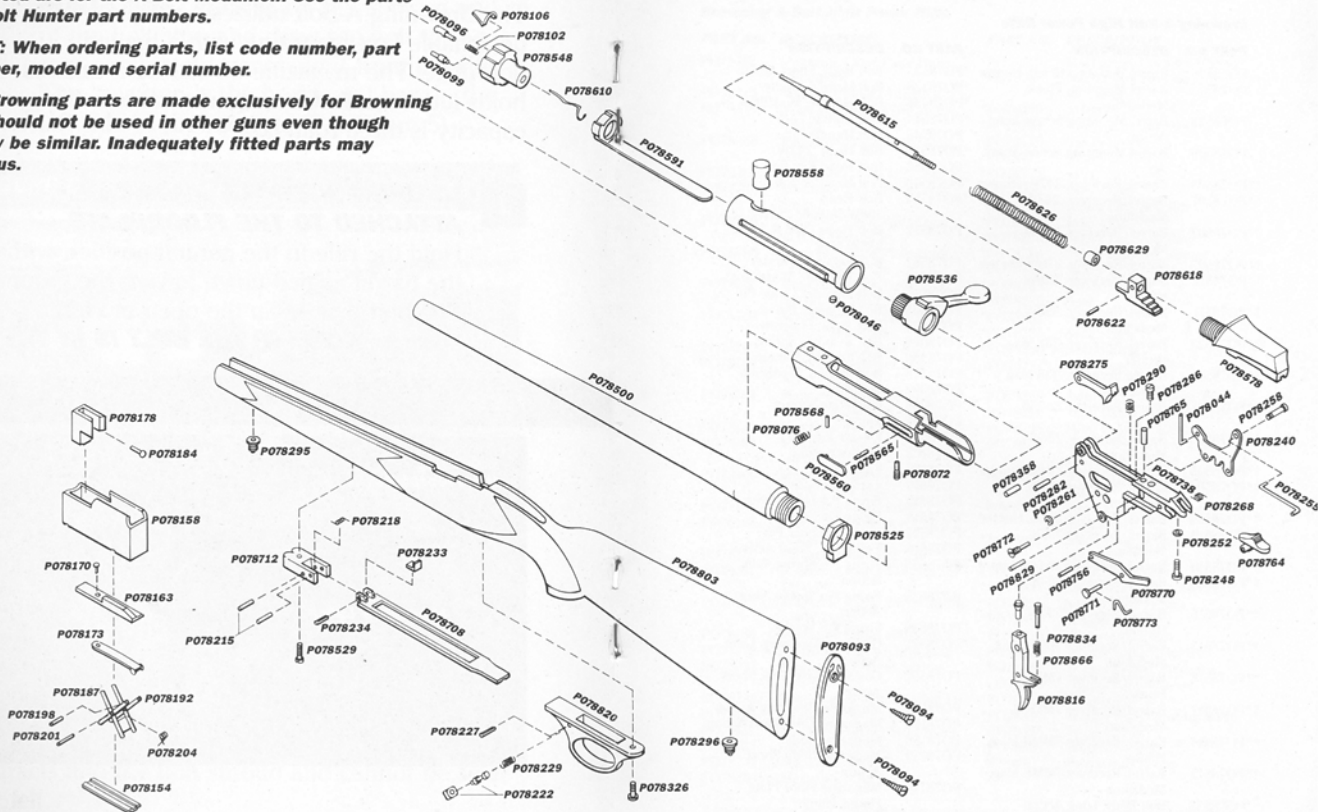

Parts List

Browning A-Bolt High Power Rifle

| PART NO. | DESCRIPTION | PART NO. | DESCRIPTION |
|-----------|-------------------------------------|----------|--|
| PO78526 | Barrel Mounting Block, Hunter | *PO78533 | Bolt Body, Short Action |
| PO78525 | Barrel Mounting Block, Medallion | *PO78538 | Bolt Handle, Hunter |
| PO78528 | Barrel Mounting Screw, Long Action | *PO78536 | Bolt Handle, Medallion |
| PO78529 | Barrel Mounting Screw, Short Action | *PO78544 | Bolt Handle Lock |
| †*PO78508 | Barrel/Receiver .243W, Hunter | PO78546 | Bolt Handle Pin |
| †*PO78507 | Barrel/Receiver .243W, Medallion | *PO78549 | Bolt Head .243W |
| †*PO78502 | Barrel/Receiver .270W, Medallion | *PO78558 | Bolt Head Key Pin |
| †*PO78503 | Barrel/Receiver .270W, Hunter | *PO78548 | Bolt Head 22-250 |
| †*PO78512 | Barrel/Receiver .308W, Hunter | *PO78550 | Bolt Head 308W-7MM-08-257R 300W 338W Mag |
| †*PO78511 | Barrel/Receiver .308W, Medallion | PO78562 | Bolt Retainer, Hunter |
| †*PO78522 | Barrel/Receiver .338 Mag, Hunter | PO78560 | Bolt Retainer, Medallion |
| †*PO78521 | Barrel/Receiver .338 Mag, Medallion | PO78565 | Bolt Retainer Guide Pin |
| †*PO78501 | Barrel/Receiver 22-250, Hunter | PO78568 | Bolt Retainer Pin |
| †*PO78500 | Barrel/Receiver 22-250, Medallion | PO78072 | Bolt Retainer Screw |
| †*PO78505 | Barrel/Receiver 25-06, Hunter | PO78076 | Bolt Retainer Spring |
| †*PO78504 | Barrel/Receiver 25-06, Medallion | PO78580 | Bolt Shroud, Hunter |
| †*PO78520 | Barrel/Receiver 257R, Hunter | PO78578 | Bolt Shroud, Medallion |
| †*PO78519 | Barrel/Receiver 257R, Medallion | *PO78093 | Butt Plate |
| †*PO78510 | Barrel/Receiver 30-06, Hunter | PO78094 | Butt Plate Screws |
| †*PO78509 | Barrel/Receiver 30-06, Medallion | PO78096 | Ejector |
| †*PO78516 | Barrel/Receiver 300W Mag, Hunter | PO78099 | Ejector Pin |
| †*PO78515 | Barrel/Receiver 300W Mag, Medallion | PO78102 | Ejector Spring |
| †*PO78518 | Barrel/Receiver 7MM-08, Hunter | PO78106 | Extractor |
| †*PO78517 | Barrel/Receiver 7MM-08, Medallion | PO78610 | Extractor Spring |
| †*PO78514 | Barrel/Receiver 7MMR Mag, Hunter | PO78615 | Firing Pin Long Action |
| †*PO78513 | Barrel/Receiver 7MMR Mag, Medallion | PO78618 | Firing Pin Sear |
| *PO78532 | Bolt Body, Long Action | PO78622 | Firing Pin Sear Pin |
| | | PO78616 | Firing Pin, Short Action |
| | | PO78626 | Firing Pin Spring, Long Action |
| | | PO78625 | Firing Pin Spring, Short Action |
| | | PO78629 | Firing Pin Washer |
| | | *PO78591 | Gas Stop Assembly, Long Action |
| | | *PO78592 | Gas Stop Assembly, Short Action |
| | | PO78154 | Magazine Base Reg Action |
| | | PO78156 | Magazine Base, Short Action |
| | | PO78158 | Magazine Body |
| | | PO78159 | Magazine Body Short Action |
| | | PO78714 | Magazine Floor Plate Hinge, Hunter |

Browning A-Bolt High Power Rifle

| PART NO. | DESCRIPTION | PART NO. | DESCRIPTION |
|----------|--|----------|------------------------------------|
| PO78712 | Magazine Floor Plate Hinge, Medallion | *PO78739 | Mechanism Housing, Hunter |
| PO78215 | Magazine Floor Plate Hinge Pin | *PO78738 | Mechanism Housing, Medallion |
| PO78218 | Magazine Floor Plate Hinge Spring | *PO78240 | Safety |
| PO78222 | Magazine Floor Plate Latch Assembly | *PO78765 | Safety Blocking Pin |
| PO78227 | Magazine Floor Plate Latch Pin | *PO78770 | Safety Lever |
| PO78229 | Magazine Floor Plate Latch Spring | *PO78771 | Safety Lever Pin |
| PO78709 | Magazine Floor Plate Long Action, Hunter | *PO78773 | Safety Lever Spring |
| PO78708 | Magazine Floor Plate Long Action, Medallion | *PO78255 | Safety Link |
| PO78711 | Magazine Floor Plate Short Action, Hunter | *PO78756 | Safety Link Roll Pin |
| PO78710 | Magazine Floor Plate Short Action, Medallion | *PO78258 | Safety Pin |
| PO78170 | Magazine Follower Rivet | *PO78261 | Safety Pin Snap Ring |
| PO78163 | Magazine Follower, Short Action 22-250 | *PO78766 | Safety Selector, Hunter |
| PO78164 | Magazine Follower, Short 243 308 257R 7MM-08 | *PO78764 | Safety Selector, Medallion |
| PO78173 | Magazine Follower Spring | *PO78268 | Safety Spring |
| PO78162 | Magazine Follower 25/06 30/06 270W | *PO78275 | Sear |
| PO78166 | Magazine Follower 7MM 300W 338W Mag | *PO78282 | Sear Pin |
| PO78184 | Magazine Ramp Rivet | *PO78286 | Sear Screw |
| PO78185 | Magazine Ramp Rivet, Short Action | *PO78290 | Sear Spring |
| PO78178 | Magazine Ramp 22-250 | PO78297 | Sight Assembly Rear, Williams Type |
| PO78181 | Magazine Ramp 243 308 257 7MM-08 | PO78298 | Sight Front, Williams Type |
| PO78176 | Magazine Ramp 25/06 30/06 270W 7MM | PO78299 | Sight Ramp, Williams Type |
| PO78180 | Magazine Ramp 300W Mag | *PO78296 | Sling Swivel Base Rear |
| PO78179 | Magazine Ramp 338W Mag | *PO78805 | Stock Long Action Mag., Medallion |
| PO78233 | Magazine Retainer Spring New Style | *PO78806 | Stock Long Action Mag., Hunter |
| PO78234 | Magazine Retainer Spring Pin | *PO78802 | Stock Long Action Std., Medallion |
| PO78198 | Magazine Spring Pin | *PO78801 | Stock Long Action Std., Hunter |
| PO78187 | Magazine Spring Strut Inner | *PO78808 | Stock Short Action, Hunter |
| PO78192 | Magazine Spring, Strut Outer | *PO78803 | Stock Short Action, Medallion |
| PO78201 | Magazine Strut Pin | *PO78295 | Swivel Base Front |
| PO78204 | Magazine Strut Spring | *PO78816 | Trigger A-Bolt |
| | | *PO78876 | Trigger Assembly |
| | | *PO78821 | Trigger Guard, Hunter |
| | | *PO78820 | Trigger Guard, Medallion |
| | | PO78826 | Trigger Guard Screw |
| | | *PO78829 | Trigger Pin |
| | | *PO78834 | Trigger Pull Adjusting Screw |
| | | *PO78845 | Trigger Sear |
| | | *PO78866 | Trigger Spring |
| | | P28401 | Pair Swivel Loops |

* Indicates part must be fitted by Browning Service Department or qualified gunsmith.

† Part may be purchased only by holders of current, valid Federal Firearms License.

CLOSED POSITION, BE SURE THE SAFETY IS IN THE "ON SAFE"

POSITION. Hold the rifle with either hand at the forearm. Depress the magazine latch in front of the trigger guard with the index finger of your free hand and allow the hinged floorplate-magazine unit to swing downward (See figure 7).

FIGURE 8



Lay a round on top of the follower and press down with your thumb until it is retained in the magazine. Care should be exercised in positioning each cartridge so that its base is flush with the rear of the

magazine. If the nose of a cartridge protrudes beyond the front of the magazine, it could cause feeding problems or interfere with the closing of the magazine floorplate (See figure 8).

After loading the magazine, swing the floorplate upwards until it is retained by the magazine latch. The bolt may be cycled at any time you wish to load the chamber. Slide the thumb safety to the rear to **PLACE THE LOADED RIFLE IN "ON SAFE" STATUS.** The magazine-floorplate unit may be opened at any time to refill the magazine to capacity.

FIGURE 9



2 **LOADING WITH THE MAGAZINE WHEN DETACHED FROM THE FLOORPLATE — PLACE THE RIFLE'S SAFETY IN THE "ON SAFE" POSITION. BE SURE THE MUZZLE IS POINTED IN A SAFE DIRECTION.**

With the magazine-floorplate unit open, the magazine may be detached by merely pulling it away from the hinged floorplate. Grasp the sides of the magazine, toward the front, then pull the magazine away from the floorplate (See figure 9).

The rifle may be supported in its barrel down position during this procedure with the opposite hand at the forearm. Once the magazine has been detached, it may be reloaded with cartridges as described under "Loading with the magazine attached to the floorplate."

FIGURE 10

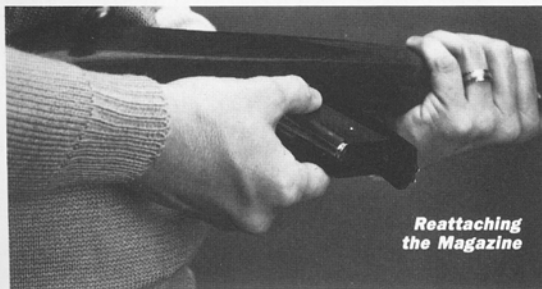

To reattach, insert the small lip on the rear face of the magazine into the matching groove in the back end of the floorplate (See figure 10). Then snap the front of the magazine firmly into place. Extra magazines may be carried loaded for rapid replacement of an empty magazine, using this same procedure. After loading the magazine, swing it up into place until it is retained by the magazine latch.

3 **CONVENTIONAL LOADING PROCEDURE**

The A-Bolt rifle may also be loaded like most other bolt action rifles. Cartridges are inserted down into the magazine through the ejection port. Place a cartridge on top of the follower and push it down into the magazine until it snaps in. After filling the magazine to capacity, a cartridge can be placed in the chamber by simply working the action.

4 **LOADING TO FULL CAPACITY** — If you wish to load a round into the chamber after loading the magazine, draw the bolt rearward to the fully rearward position. Then close the bolt chambering a round. **PLACE THE SAFETY IN THE "ON SAFE" POSITION.** Lower the floorplate and refill the magazine to capacity as previously described. The magazine-

floorplate may be opened at any time for reloading.

If you are loading through the ejection port, as explained under "Conventional Loading Procedure," you can load to full capacity by first filling the magazine to capacity, then manually thumbing a round into the chamber, and pushing the cartridges in the magazine down while closing the bolt. **IMMEDIATELY PLACE THE SAFETY IN THE "ON SAFE" POSITION.**

Unloading the rifle

WITH THE SAFETY IN THE "ON SAFE" POSITION, AND THE MUZZLE POINTED IN A SAFE DIRECTION, release the magazine floorplate to its open position. Move the safety to "off safe" and draw the bolt to its rear or open position. This will extract and eject any live round that may be in the chamber. As a good safety practice, **ALWAYS VISUALLY INSPECT THE CHAMBER TO BE ABSOLUTELY SURE A LIVE ROUND IS NOT PRESENT.** The magazine may then be detached and either kept loaded or the cartridges may be stripped from the magazine with your thumb. To do this, push forward on the base of each round with your

thumb until the cartridge clears the retaining rims. You can close the floorplate either without the magazine or with an empty magazine in place. The bolt may now be returned to the closed position.

Scope Mount

All calibers are drilled and tapped for scope mounts. See your Browning dealer to purchase the scope mount base and rings designed for the A-Bolt. Ask for the two-piece scope mount base, #8417 and standard rings, #9117.

FIGURE 11

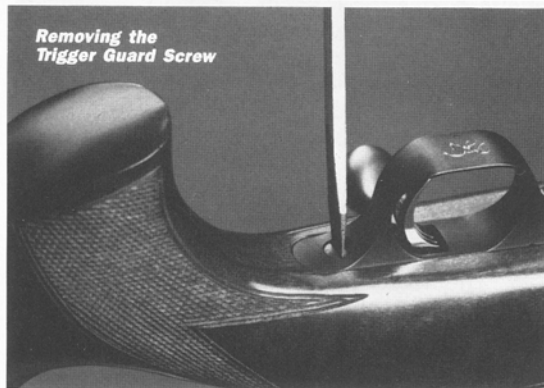

Trigger Adjustment

- 1 The A-Bolt's trigger is preset at the factory. The trigger pull can be adjusted within a range of approximately 3 to 6 pounds. To adjust the trigger pull, first **MAKE CERTAIN THAT THE RIFLE IS UNLOADED.** Next lower the floorplate and carefully remove the trigger guard screw (See figure 11). Lift the trigger guard out of the stock (See figure 12).

FIGURE 12

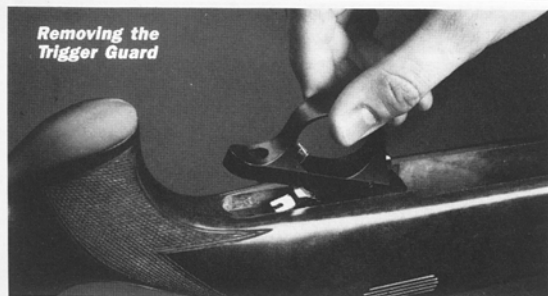

- 2 The trigger pull adjustment screw is located at the rear of the trigger assembly (See figure 13). To decrease the weight of the trigger pull, turn the adjustment screw in a clockwise direction using a small

FIGURE 13

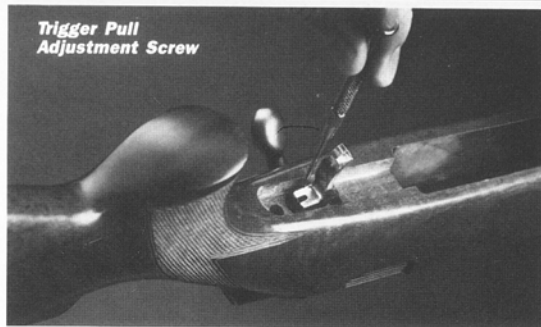

screw driver. To increase the trigger pull, turn the adjustment screw in a counter-clockwise direction. NOTE: If trigger pull is increased too much, the trigger cannot be pulled. Turn the screw clockwise until trigger can be pulled.

- 3 Trigger pull can be measured, with the bolt closed, using a very accurate spring scale or a commercially available set of trigger pull measuring weights. Most gunsmiths can also measure trigger pull for you.
- 4 When finished making the adjustment, place the trigger guard back in the stock and reinstall the trigger guard screw snugly.

Swivels

The Browning A-Bolt Medallion is equipped with a set of low profile sling swivel bases and loops. The Hunter model is equipped with a set of rugged post-style sling swivel bases only.

Care and Cleaning

The correct procedure for cleaning your A-Bolt is as follows: **BE CERTAIN THE RIFLE IS UNLOADED AND THE BOLT HAS BEEN REMOVED.**

1 USE A CLEANING ROD WITH A TIP AND PATCH LARGE ENOUGH FOR A SNUG FIT IN THE BORE. Insert the rod and patch into the barrel at the breech end and run it back and forth several times. Do not insert the rod at the muzzle end as the rod or handle could strike the crown of the muzzle. Damage to this area can affect the accuracy of the rifle.

2 INSPECT THE CHAMBER AND BORE FOR POWDER FOULING. A normal amount of powder residue can be expected and is not serious. It can usually be

removed by repeating step No. 1, using a patch saturated with nitro solvent. If or when fouling should become heavy, it can be removed with a brass bore brush. Dip or spray the brush with nitro solvent and scrub the chamber and bore until the fouling is removed. To prevent brass bristles from breaking off, the brush should be pushed completely through the bore before being withdrawn.

3 AFTER FOULING HAS BEEN REMOVED, THE BORE SHOULD BE WIPED DRY.

Then pass a slightly oiled patch through the bore, for preservation. A fine, light gun oil like Browning Oil is recommended.

4 THE INTERIOR OF THE RECEIVER AND THE BOLT SHOULD PERIODICALLY BE WIPED OFF WITH A CLEAN RAG.

Remove the bolt occasionally and wipe clean. Any dried oil in the receiver area should also be removed. Follow this cleaning with a very light film of oil on working parts. Do not pour large quantities of oil into the action. An excess of oil will run into the wood and cause it to soften or warp.

5 WIPE ALL EXPOSED METAL SURFACES WITH AN OILED CLOTH MAKING SURE TO WIPE THE RIFLE CLEAN OF ALL FINGER MARKS.

Finger marks should be removed because they provide a place where moisture can accumulate. Ordinary good judgment will, of course, indicate that the metal of the gun should receive a light film of oil any time the rifle has been exposed to weather or handling.

6 THE WOOD SURFACES OF YOUR A-BOLT CAN ALSO BE WIPED LIGHTLY WITH BROWNING OIL,

or you can apply a quality wood or furniture polish to the stock and forearm. Using one of these methods (not both), will enhance the beauty and durability of your A-Bolt.

Disassembly

Do not take the A-Bolt rifle apart any more than is suggested above and in the trigger pull adjustment section. Should it ever be necessary for more complete disassembly (if the rifle is dropped in water for example) the task should be undertaken only by a competent gunsmith or at one of the Browning Recommended Service Centers.

Cleaning the magazine

Depending on how often you shoot, it is helpful to disassemble the box magazine for cleaning. First, remove the detachable box magazine from the rifle. Slide the magazine bottom plate out to the rear. The magazine spring and follower can then be easily removed for inspection. Wipe off any dirt or residue then apply a very thin coat of oil and wipe clean again. Too much oil will only serve to collect oil and dirt. To reassemble, reinsert the spring and follower, then slide the bottom plate back into position (See figure 14).

FIGURE 14

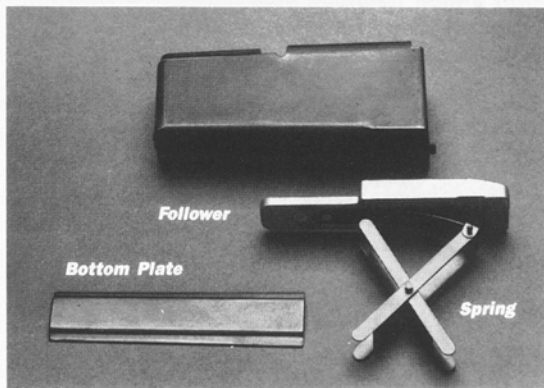

Service or Repair

If your firearm should require service or repairs, we suggest you first contact a local recommended Browning Firearms Service Center. Your Browning Sporting Goods dealer can tell you the address of the Service Center nearest you, or you may call or write our Consumer Information Department:

**Browning Consumer Information
Route One
Morgan, Utah 84050
Phone: (801) 876-2711**

Otherwise you may return your firearm to our own repair facility for servicing. The address is:

**Browning Service Department
3005 Arnold Tenbrook Road
Arnold, Missouri 63010-9406
Phone: 1-800-322-4626**

Canadian Customers call or write:

**Browning Canada Sports Ltd./Ltee,
5617 Chemin St-Francois
St-Laurent, Quebec H4S 1W6
Phone: (514) 333-7261**

When returning your firearm for servicing, please be sure it is unloaded, and that it is packaged securely in a cardboard container. Under no circumstances should ammunition be returned as it is against postal and most commerce regulations. **YOU MUST ENCLOSE A LETTER WITH THE GUN** that clearly describes the trouble experienced and the repairs or alterations desired.

Other Browning Products



SPORTSMAN'S KNIVES

There is a folding or fixed blade Browning knife to match nearly every requirement — including fillet, pocket, skinning and general utility style knives. Every Browning knife is manufactured using the finest materials and the most hand-pleasing designs. Each Browning knife is distinctive in quality and style the way a good knife should be.



FISHING TACKLE

You'll catch more fish and have more fun with a quality Browning fishing rod or reel. There's a rod for every fishing trip — from pack rods for traveling, to heavy rods for deep sea action. Top quality reels come in sizes for practically any fishing situation. Also choose from Browning's complete line of quality accessories.



BROWNING OIL

Browning Oil is the best all-around oil for your guns. It cleans, lubricates, and protects metal and bluing. It is designed to function in extreme temperatures and provides excellent anti-rust protection. Browning Oil is also ideal for many other applications including household, automotive, and fishing tackle. Available in drip spout or aerosol can.



SPORTSMAN'S CLOTHING

Hunting, fishing, or treks to the shopping mall, you know that your Browning clothing will do its job well. For the sportsman who spends time in wet, cold weather, Browning makes a complete line of waterproof Gore-Tex® clothing. Hats, gloves and handsome leather belts are also available.

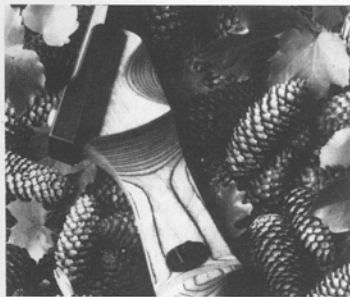

ARCHERY EQUIPMENT

Browning has a complete line of compound bows suited for recreation and hunting. Handsome styling, coupled with exceptional speed and accuracy is something you can count on with every Browning bow. There is a draw weight, draw length, and bow size for nearly every shooter.

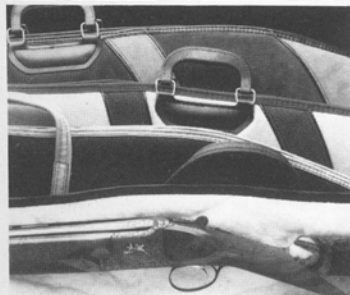

GUN CASES

Your guns are well protected in a Browning flexible gun case. Exteriors of genuine leather, attractive vinyl, rugged canvas or tough, water-repellent Cordura nylon are available for nearly any size gun. Soft inner linings protect your gun's finish. Our luggage cases are of scuff resistant, leather-textured vinyl and lined with polyester fleece fabric, giving you unmatched protection for your Browning shotguns and rifles.



SPORTING ARMS

World famous for handcrafted quality and dependability, Browning Sporting Arms include a complete line of shotguns and high power or small bore caliber rifles and pistols.



BROWNING PRO-STEEL GUN SAFES

Protect your guns and other valuables from today's rising theft rate. No other safe gives you the protection you get from Browning Pro-Steel's Gold Series safes; reinforced door and door frame, extensive hard plate, heavy steel plate construction, and independent, active locking lugs.

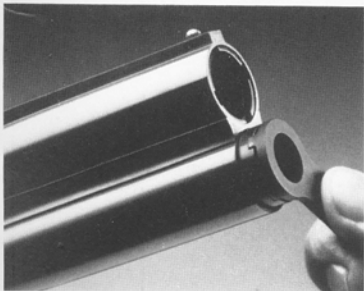

INVECTOR CHOKE TUBE SYSTEM

Most Browning shotguns are available with the Invector Choke Tube system. Tubes for all popular chokes install in seconds and recess completely inside the muzzle. No projecting knurled rings or flanges to distract your aim or spoil the looks of your Browning shotgun.



BROWNING